

Ratio 1:1 Flow rate 23 l/min

Ratio 1:1 Flow rate 40 l/min

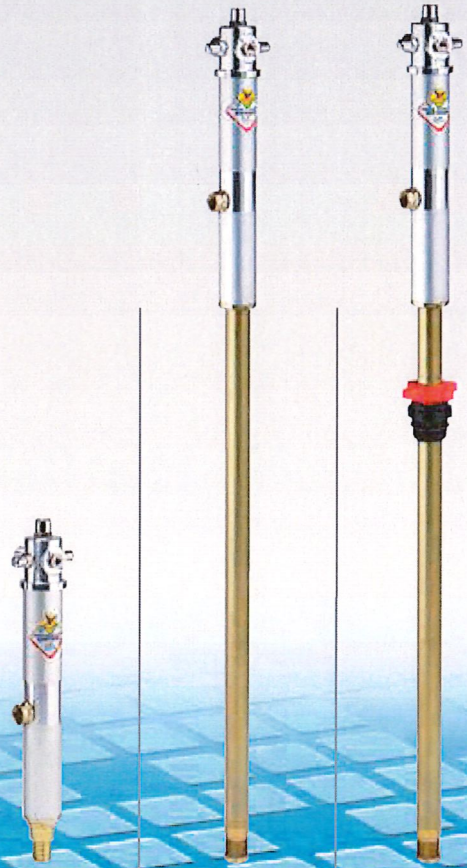
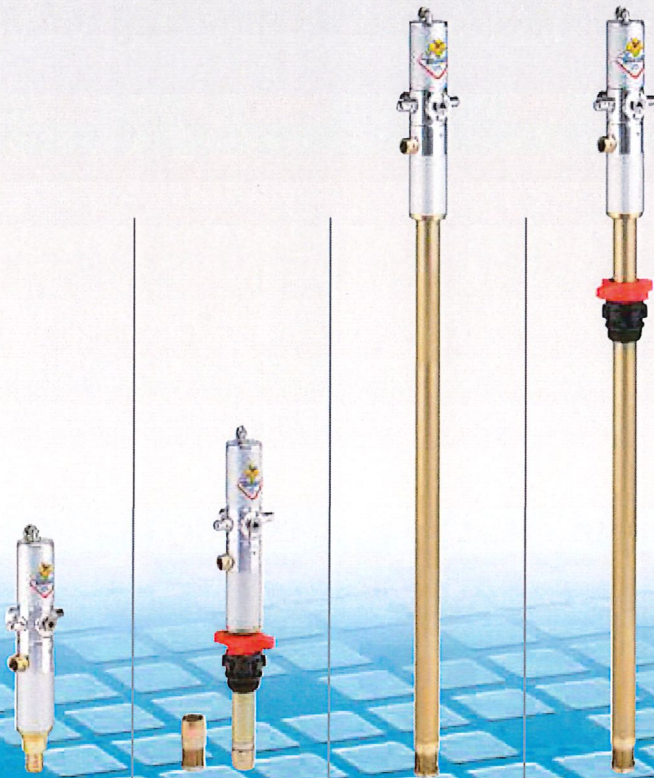

series 600

serie 650

33080	33081	33082	33083
33070	33071	33072	33073
33060	33061	33094	33096

33170	33172	33173
33160	33194	33196

Oils, lubricants and similar

Oils, lubricants and similar

Aluminum
Carbon steel

Aluminum
Carbon steel

F 1/4" G	F 1/4" G	F 1/4" G	F 1/4" G
F 1/2" G	F 1/2" G	F 1/2" G	F 1/2" G
6 - 8	6 - 8	6 - 8	6 - 8
230	230	230	230
81	81	81	81
80	80	80	80
-	standard	-	standard

F 1/4" G	F 1/4" G	F 1/4" G
F 3/4" G	F 3/4" G	F 3/4" G
6 - 8	6 - 8	6 - 8
370	370	370
81	81	81
130	130	130
-	-	standard

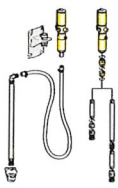

modular

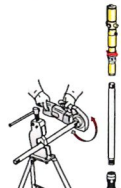

customisable 1"

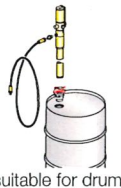

suitable for drums
180-220 kg

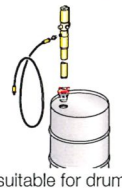

suitable for drums
180-220 kg

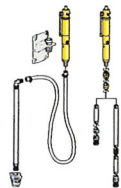

modular



suitable for drums
180-220 kg

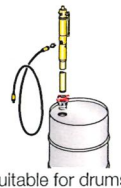

suitable for drums
180-220 kg

1 - 0,006

1 - 0,006

1 - 0,020

1 - 0,020

1 - 0,010

1 - 0,020

1 - 0,020

35,5 - 0 - 0

35,5 - 22 - 4,2

35,5 - 94 - 4,2

35,5 - 94 - 4,2

50,5 - 0 - 0

50,5 - 94 - 4,2

50,5 - 94 - 4,2

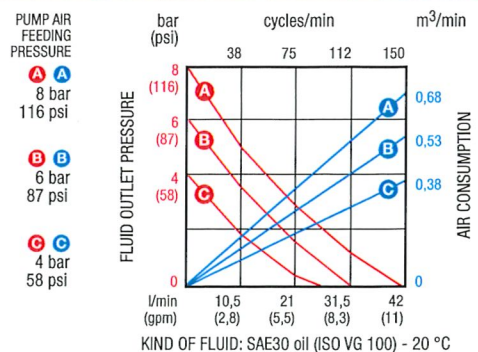
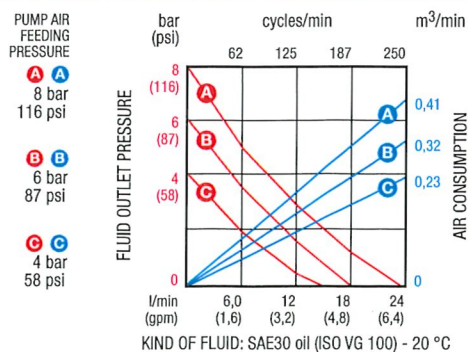



Stainless steel AISI 304 pumps for TRANSFER

Ratio **1:1** Flow rate **30 l/min**

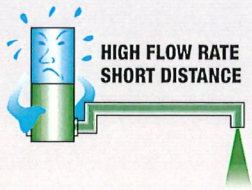

Stainless steel AISI 304 air-operated pumps for short-medium distance transfer. Ideal for transferring low-medium viscosity fluids such as: antifreeze liquid, windshield washing liquid and chemical products.

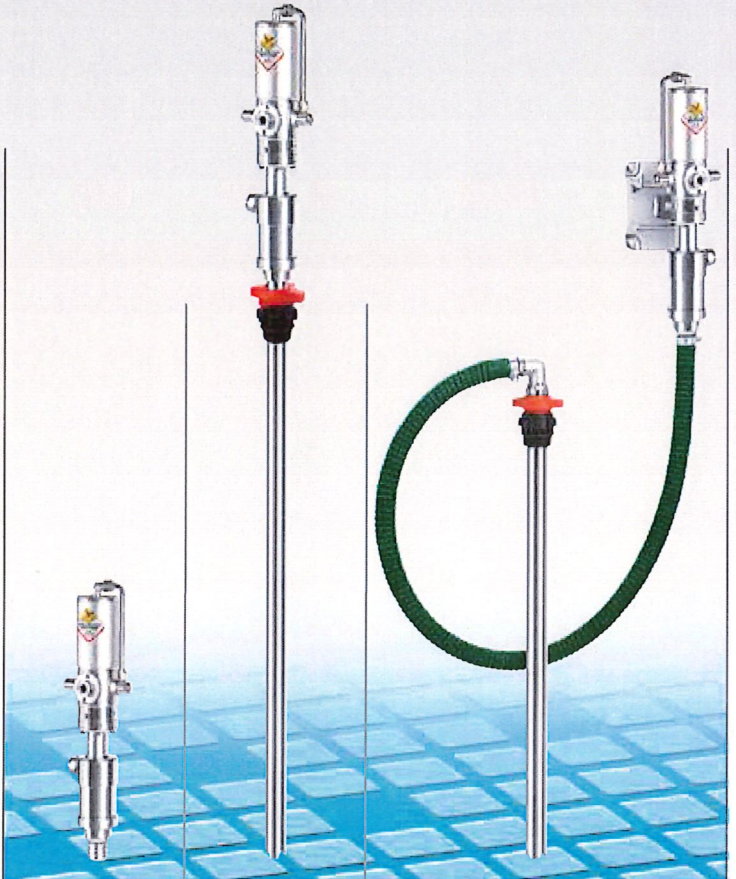
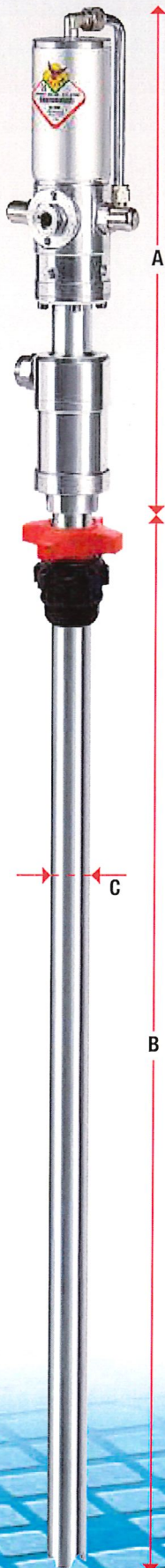

series **600 INOX**

Article with seals in	Viton®	33360	33396	33300
Compatible fluids		Suitable for antifreeze and windshield washing liquid		
Suction tube lower body		Stainless steel AISI 304		
Suction tube		Stainless steel AISI 304		
Air inlet connection	bsp	F 1/4" G	F 1/4" G	-
Fluid outlet connection	bsp	F 1/2" G	F 1/2" G	-
Air working pressure	bar	6 - 8	6 - 8	-
Average air consumption	l/min	370	370	-
Noise level	dB	81	81	-
Max deliverable oil viscosity	SAE	50	50	-
Bung adaptor		-	standard	33434
Suitable for drums or tanks				
Packing	N° - m³	1 - 0,10	1 - 0,020	1 - 0,29
Weight	kg	5,3	7,4	11,4
Dimensions (A - B - C)	cm	41 - 0 - 0	41 - 94 - 3,4	41 - 94 - 3,4

Art. 33445
Gun for antifreeze and windshield liquid applicable to kit Art. 33300 equipped with:
- inlet joint F 1/2"
- stainless steel rigid terminal with free outlet

