

CAR-O-LINER®

CMI™ 300 PULSE
ADVANCED YET SIMPLE

CMI 300

CAR-O

CMITM 300 PULSE

ADVANCED YET SIMPLE

The Car-O-Liner's **CMI300 Pulse** is the welding machine for repairing cars and building up car bodies in professional workshops.

It is designed to meet carmakers' standards for joining processes in thin high-tensile steel, aluminium and stainless steel.

READY FOR AUTO BUSINESS

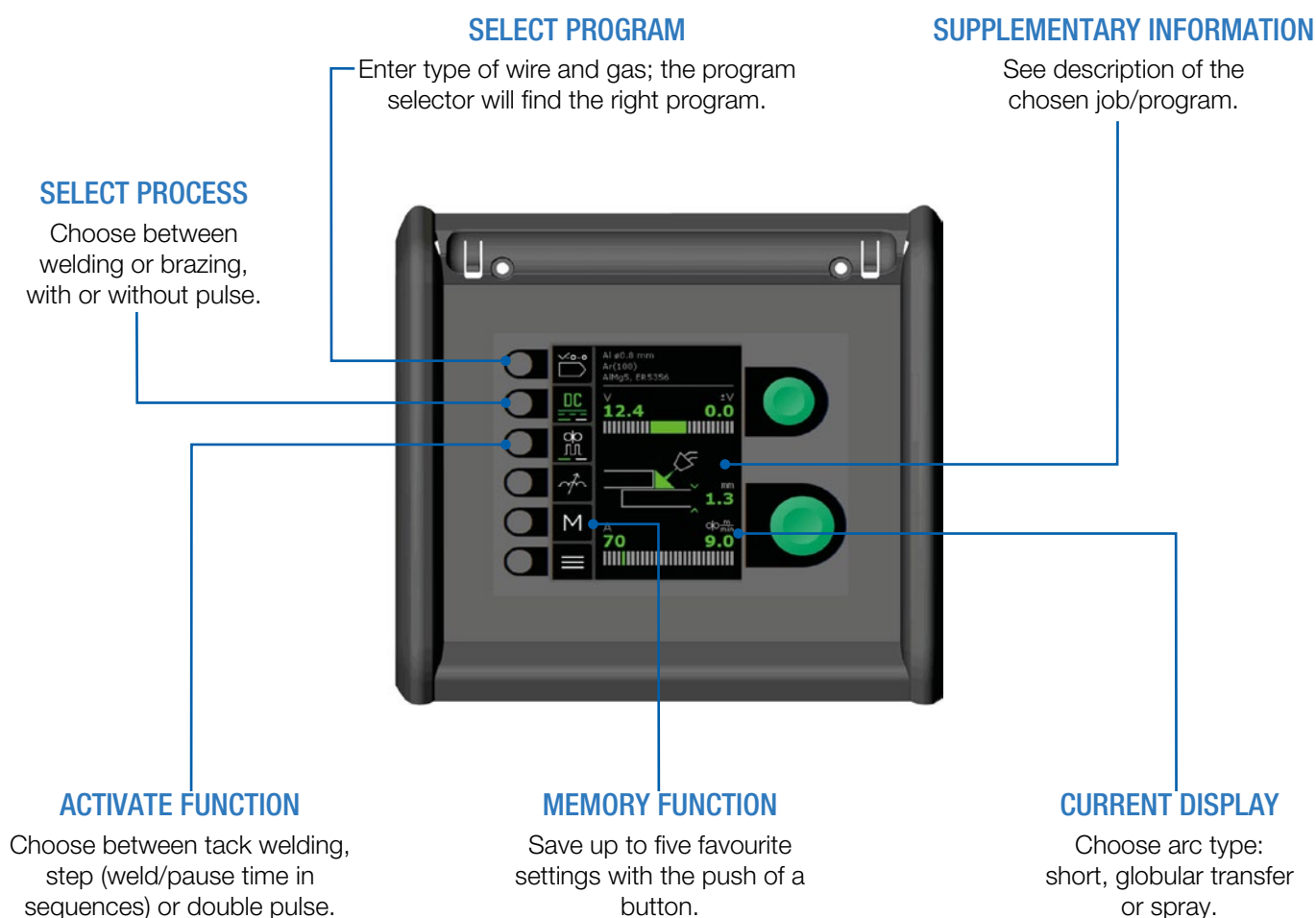

COMPACT AND FULLY DIGITAL WELDING MACHINE

EASY SWITCH-OVER WITH DUO OR TRIO

The **CMI300** Pulse is available in three versions: SINGLE, DUO and TRIO. The DUO version has room for two 15kg wire coils and the TRIO version for three 5kg wire coils, providing easy switch-over between operations without change of hose, wire, wire drive rolls and gas. The machine will automatically establish which torch/wire feed unit is active.

MIG BRAZING

In addition to sheet metal welding, the **CMI300** Pulse features MIG brazing with and without pulse of galvanised steel plates.

This function ensures maintenance of the materials in terms of corrosion and strength and reduces post-treatment of distortion of plates and profiles to a minimum. The result is cost-effective and efficient welding.

OUR WELDING EXPERTISE

FOCUSED ON YOUR RESULTS

PERFECT FOR JOINING SHEET METALS AND BUILDING UP CAR BODIES.

CMI300 PULSE WITH 36 PRE-SET PROGRAMS

The programs meet the requirements for welding and brazing, for example for high-tensile steel and aluminium, which are used by the auto business.

DOUBLE PULSE FOR WELDING AND BRAZING

CMI300 Pulse features double pulse – a function required by several OEMs.

BOOST FOR ALL MAINS VOLTAGES

The **CMI300 Pulse** is available with built-in Boost Converter (electronic auto transformer) for welding on all mono-phase and three-phase mains voltages from 208V to 440V (50/60 Hz).

IGC® — OPTIMAL SHIELDING OF WELD POOL

IGC (Intelligent Gas Control)* ensures optimal shielding of the weld pool and maintains the strength in the joint in the best way possible. The result is large-scale gas savings and a minimum of weld spatter.

MIG-A TWIST®

The ergonomic **MIG-A Twist** torch has a turnable swan neck for easy access to hard-to-reach locations.

MIG-A Twist is available in different lengths and with different swan necks. It is configurable with different control units for adjustment of welding current at the torch handle. The control unit is easy to exchange as required without the use of tools.

FEATURES AND BENEFITS

- **DOUBLE PULSE** ensures precise control of the arc and minimises weld spatter
- **FOUR-ROLL WIRE SYSTEM** for stable wire feeding
- **TACHO CONTROL** of wire motor for ultra precise feeding
- **LED LIGHT** in the wire console for easy change of wire and wire rolls in low-light environment
- **SOFT-KEY CONTROL PANEL** with colour display and an intuitive icon-based menu
- **ARC ADJUST** function for precision adjustment between soft and hard arc
- **SOFTWARE UPDATE** via SD card
- **LOG FOR STORAGE** and display of welding data on an SD card, applicable for documentation of compliance with repair procedures*



*Available as optional feature

CAR-O-LINER®

PRODUCT INFORMATION

AND TECHNICAL DATA

TECHNICAL DATA

SPECIFICATION	CMI300 PULSE SINGLE	CMI300 PULSE DUO	CMI300 PULSE TRIO
Mains voltage $\pm 15\%$, (50-60Hz) V	3x400	3x400	3x400
Current range, A	15 - 300	15 - 300	15 - 300
Minimum generator size, kVA	16	16	16
Duty cycle 100% /40°, A / V	200 / 100 / 24.0	200 / 100 / 24.0	200 / 100 / 24.0
Duty cycle 100% /40°, A / V	230 / 60 / 25.5	230 / 60 / 25.5	230 / 60 / 25.5
Duty cycle max. /40°, A / % / V	300 / 20 / 29.0	300 / 20 / 29.0	300 / 20 / 29.0
Duty cycle 100% /20°, A / V	250 / 100 / 26.5	250 / 100 / 26.5	250 / 100 / 26.5
Duty cycle max. /20°, A / % / V	300 / 60 / 29.0	300 / 60 / 29.0	300 / 60 / 29.0
Open circle voltage, V	50-60	50-60	50-60
Protection class (for outdoor use)	IP 23S	IP 23S	IP 23S
Norm	IEC60974-1. IEC60974-5. IEC60974-10 Cl. A		
Dimensions (H x W X L)	838x443x1003mm (32.99x17.44x39.48in)	1104x597x1003mm (32.99x17.44x39.48in)	1104x597x1003mm (32.99x17.44x39.48in)
Weight	49kg (108.02lb)	63kg (138.89lb)	67kg (147.71lb)

49467 CMI300 PULSE 2020-03 BROCHURE EN



CAR-O-LINER®

www.car-o-liner.com



Car-O-Liner® (2020) is a trademark of Snap-on® Incorporated. All rights reserved.

Product images are for illustrative purposes only and may differ from the actual product. Car-O-Liner reserves the right to modify any content without prior notice.