

# Major 4030-44 WL DLX

Electro-hydraulic 4-post lift, 4 t capacity



## Application

- Check-in
- Repair and maintenance
- Wheel alignment
- MOT Testing

## Approvals / recommendations

- BMW/Mini

## Description:

### Posts:

- Integrated eccentric brake system
- Emergency stop valve
- Obstruction system
- Pneumatic parking system in height adjustable ratchets
- Pump unit with immersed motor and control unit on rear left post
- Pushbutton control unit with alarm signal
- Soft lowering for the last 150 mm above the floor
- Hydraulic cylinder under left platform
- Lifting and lowering by means of cables
- Emergency lowering valve

### Platforms:

- One moveable platforms as standard
- Platforms prepared for AUTOPSTENHOJ scissor jack
- Platforms on stable cross beam

### Standard colours:

- Platforms & posts: RAL 7016 – grey
- Ramps: RAL 3020 – red

## Versions:

- Available with different voltages
- Drive-on ramps and stops for surface-mounting, alternatively drive-over ramps for recessed installation
- 44 = 4,400 mm platforms

## Optional extras:

- Set of expansion bolts
- Extra control unit
- LED-lighting set
- Set of two cover plates for recesses
- Set of two 385 mm ramp extensions

**Special colours available on request!**



Scan the QR-Code for detailed product information.

Further Information on [www.autopstenhoj.com](http://www.autopstenhoj.com)

**autop Maschinenbau GmbH**

Sandkampstraße 90  
D-48432 Rheine  
☎ +49 5971 8602-02  
✉ [info@autopstenhoj.com](mailto:info@autopstenhoj.com)

**STENHØJ A/S**

Barrit Langgade 188-190  
DK-7150 Barrit  
☎ +45 76 82 13 30  
✉ [info@autopstenhoj.com](mailto:info@autopstenhoj.com)

**Technical data**

Lifting capacity	4,000 kg
Lifting height	1,670 mm
Working height	1,860 mm
Lifting / lowering time	35 sec.
Pump unit	3 kW
Voltage	3x230/400V – 50 Hz – 25 / 16 A

**Platforms**

Total length	4,840 mm
Usable length of platform	4,400 mm
Wheel base, min. - max.	variable
Platform width	680 mm
Distance between platforms	930 mm
Min. height	190 mm
Width between posts	3,000 mm
Total width - outer edges base plates	3,432 mm
Total height	2,233 mm

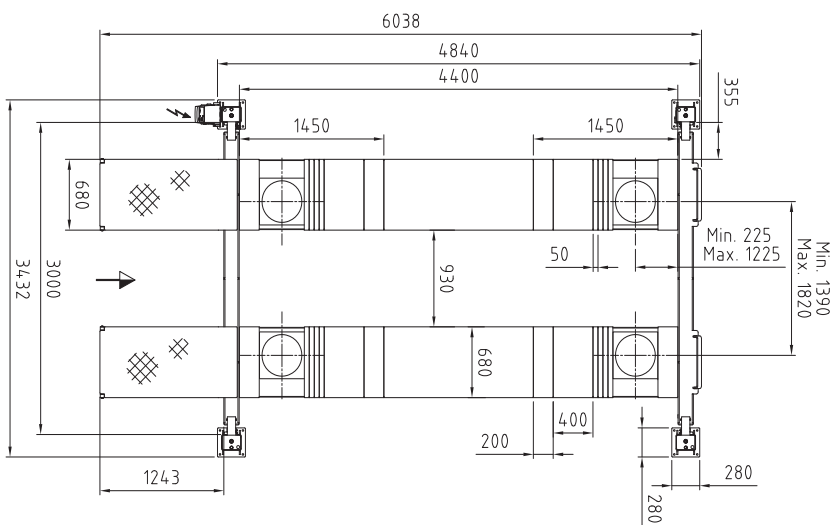

Slip plate



Ratchet for parking position



Control unit and power pack on rear left post